

# ALUMINUM ELECTROLYTIC CAPACITORS

**HZ** Ultra Low Impedance series

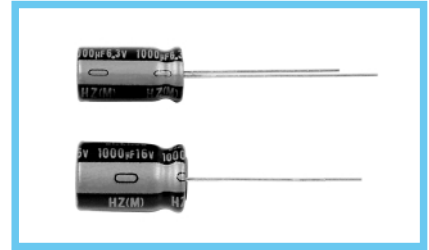

- Lower impedance than HN series.
- Adapted to the RoHS directive (2002/95/EC).



## Specifications

Item	Performance Characteristics				
Category Temperature	-25 to +105°C				
Rated Voltage Range	6.3 to 16V				
Rated Capacitance Range	470 to 3300µF				
Capacitance Tolerance	±20% (120Hz, 20°C)				
Leakage Current	After 2 minutes' application of rated voltage, leakage current is less than 0.03CV				
tan δ	For capacitance of more than 1000µF, add 0.02 for every increase of 1000µF				
	Rated voltage (V)	6.3	10	16	120Hz 20°C
	tan δ (MAX.)	0.22	0.19	0.16	
Stability at Low Temperature	Rated voltage (V)	6.3	10	16	120Hz
	Impedance ratio ZT / Z20 (MAX.)   Z-25°C / Z+20°C	3	3	3	
Endurance	After an application of D.C. bias voltage plus the rated ripple current for 2000 hours at 105°C the peak voltage shall not exceed the rated D.C. voltage, capacitors meet the characteristic requirements listed below.				
	Capacitance change	Within ±30% of initial value			
	tan δ	200% or less of initial specified value			
	Leakage current	Initial specified value or less			
Marking	Printed with gold color on black sleeve.				

## Radial Lead Type

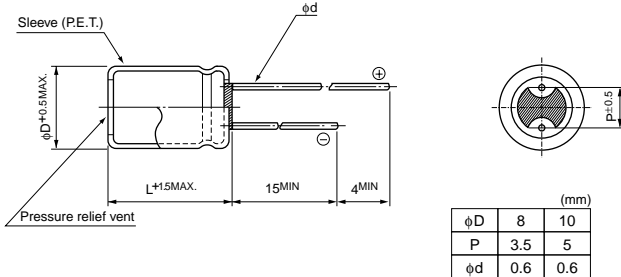

## Type numbering system (Example : 6.3V 1800µF)

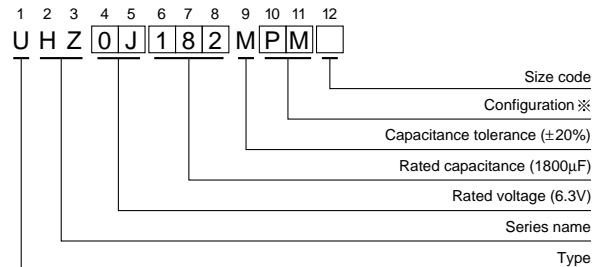

### ※ Configuration

φ D	Pb-free leadwire Pb-free PET sleeve
8 · 10	PM

## Standard ratings

Cap. (µF)	V (Code)	Item Code	6.3 (0J)			10 (1A)			16 (1C)		
			Case size φD × L (mm)	Impedance (mΩ) MAX. 20°C / 100kHz	Rated ripple (mArms) 105°C / 100kHz	Case size φD × L (mm)	Impedance (mΩ) MAX. 20°C / 100kHz	Rated ripple (mArms) 105°C / 100kHz	Case size φD × L (mm)	Impedance (mΩ) MAX. 20°C / 100kHz	Rated ripple (mArms) 105°C / 100kHz
470		471									
680		681				▲ 10 × 12.5	12	2288	▲ 10 × 12.5	12	2280
820		821				● 10 × 16	10	2960	● 10 × 16	10	2960
1000		102	▲ 10 × 12.5	12	2280	○ 8 × 20	9	2880	○ 10 × 16	10	2960
1200		122	▲ 10 × 12.5	12	2280	▲ 10 × 16	10	2960	▲ 10 × 16	10	2960
1500		152	▲ 8 × 20	9	2880	▲ 8 × 20	9	2880	▲ 8 × 20	9	2880
1800		182	▲ 10 × 16	10	2960	▲ 8 × 20	9	2880	▲ 10 × 20	7	3770
2200		222	▲ 10 × 20	7	3770	▲ 10 × 20	7	3770	▲ 10 × 20	7	3770
2700		272	▲ 10 × 20	7	3770						
3300		332	▲ 10 × 25	6.5	4690						

Please refer to page 20, 21, 22 about the formed or taped product spec.  
Please refer to page 4 for the minimum order quantity.

- ▲ : In this case, [6] will be put at 12th digit of type numbering system.
- : In this case, [3] will be put at 12th digit of type numbering system.
- : In this case, [9] will be put at 12th digit of type numbering system.